

How to use and care for your

GARVEY® Labeler

You have purchased a quality product in this labeler by Garvey®. Please study these instructions, handle the labeler with care, and you will receive long term service and satisfaction.

Loading Your Garvey® Labeler

Open the bottom hatch by pulling both black side buttons towards trigger of labeler (Fig. A). Pull hatch back so inside of labeler is exposed. Drop in Labels with side to be imprinted **facing away** from the opened hatch (Fig B). Close the hatch, leaving 8-10 labels extended outside of the hatch. Hook the extended labels behind the guide posts (Fig C.). Bring the end of the label strip back and feed it into the drive wheel (Fig.D). Squeeze the trigger several times to feed the labels through the labeler. Within a few clicks, the labeler will align itself and you will be ready to begin labeling.

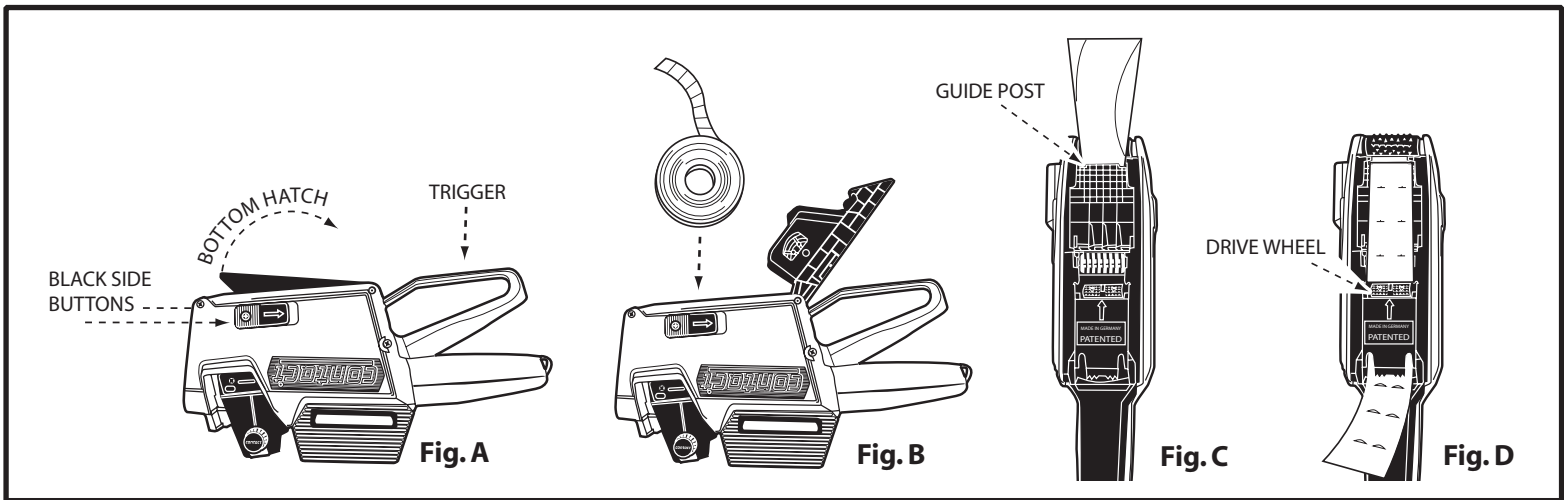

Setting the Price Code

Pull selector knob (Fig. E, No. 4) out to desired position shown by selector indicator (Fig. E, No. 5) and turn knob. The white number (Fig. E, No. 2) appearing in the window will be the same number printing. Always be sure that the **white** portion of the band is displayed in the window.

Slugs

Optional printing slug can be inserted in open slot at back of printing head. (Fig. E, No.3)

To Remove Ink Roller Cartridge

Squeeze the labeler trigger to expose the carriage (Fig. F). With your thumb and index finger, grab the ridged areas of the carriage (Fig. G, No.4) and pull outward to remove. To remove ink roller (Fig. G, No. 2) spread carriage legs apart (Fig. G, No. 3), and allow the roller to drop out.

To Replace Ink Roller Cartridge

Secure the replacement ink roll (Fig. G, No. 2) between the carriage legs (Fig. G, No. 3). With thumb and index finger, insert carriage lip (Fig. G, No. 1) into the small rectangular opening at top/front of gun at a 30-45 angle. When the lip is fully inserted into opening, push the carriage in and downward.

IMPORTANT NOTICE! THE USE OF NON-GENUINE GARVEY PRODUCTS WILL VOID THE MANUFACTURER'S WARRANTY. ANY LABELERS DETERMINED TO HAVE BEEN USED IN CONJUNCTION WITH NON-GENUINE GARVEY PRODUCTS WILL BE RETURNED TO THE CUSTOMER, UNREPAIRED AT THE CUSTOMER'S EXPENSE. IF YOUR SUPPLIER IS NOT SELLING GENUINE GARVEY PRODUCTS AND YOU WOULD LIKE INFORMATION REGARDING AN AUTHORIZED GARVEY RESELLER IN YOUR AREA, PLEASE CALL OUR TOLL-FREE NUMBER, (800) 543-1908.

